

Waterview Conference Center

1919 North Lynn Street
Arlington, VA 22209
+1-571-303-3032
sales@waterviewcc.com
www.executiveboard.com/waterview



The Waterview Conference Center, metropolitan Washington's premier event space, offers a one-of-a-kind opportunity for hosting corporate and social meetings, conferences, receptions, and retreats in the nation's capital, all high above the waters of the Potomac River.

With unrivaled views of and access to downtown, the Center is designed to showcase the best of the city while providing cutting-edge event space. It is where the best of the nation's capital converges and where an unforgettable experience continually awaits.

Facilities

More than 15,000 square feet of state-of-the-art function space, all with natural light, feature unobstructed views of downtown Washington or Rosslyn's city center.

There are 14 rooms housed across the 23rd and 24th floors of the new international headquarters of the Corporate Executive Board, a space designed to suit the needs of Fortune 500 executives.

Flexible rooms can accommodate groups from 10 to 200 for both corporate and social affairs.

Numerous pre-function spaces can be tailored for preparatory needs, small gatherings, or even exhibit space, all with unrivaled views of the nation's capital and waterfront.

All meeting space features advanced audiovisual capabilities as well as high-speed and wireless Internet access, which is also available throughout the entire conference center.

Most rooms feature built-in LCD projectors and screens, and many built-in whiteboards make for an ideal "in the moment" use.

Services

Restaurant Associates—Waterview's exclusive caterer and known throughout the city for its operations at the Kennedy Center and the House of Representatives best-in-class management of food service—offers full dining capabilities and is ready to meet even the most demanding culinary needs.

A dedicated reception team is ready to assist with any guest requests. The fully equipped business center provides access to copier, fax, and print services. Comprehensive AV support is available.

The Conference Center is connected via a covered walkway to the brand-new Hotel Palomar Arlington and is within walking distance of many other hotels, offering more than 2,000 rooms for every budget.

Location

Situated in Arlington's Rosslyn neighborhood, the Center is surrounded by a contemporary mix of dining options as well as some of the Capital Area's best-known attractions, including Arlington National Cemetery, the Iwo Jima memorial, and the Pentagon.

Ronald Reagan Washington National Airport is located just four miles away and accessible via the Rosslyn Metro Station, only two blocks from the conference center.

Twenty-three miles away, Washington Dulles International Airport also offers easy access to Rosslyn and Waterview.

The historic neighborhood of Georgetown is a short 10-minute walk from the conference center and offers even more dining and retail options.

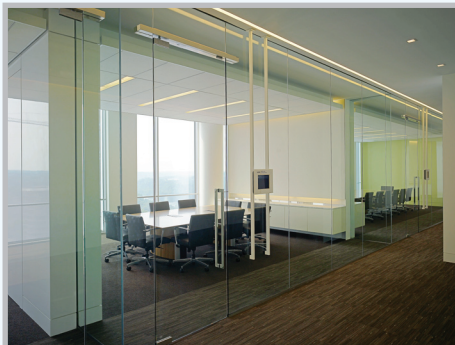

23rd Floor

Potomac River

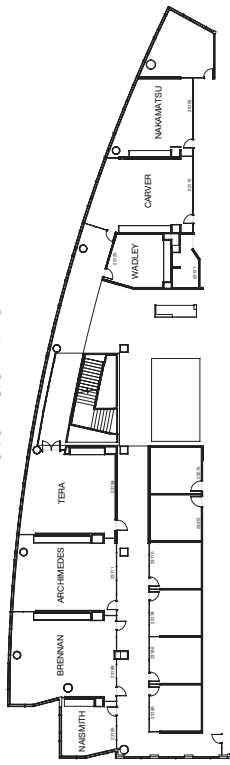

24th Floor

Potomac River

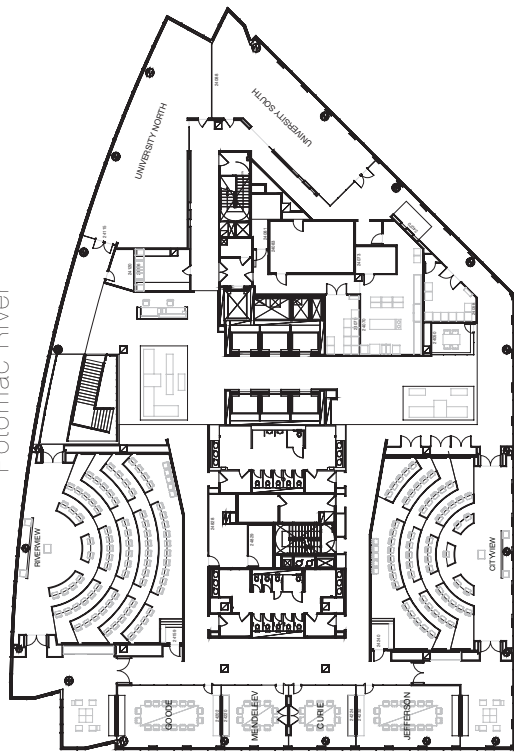

Floor	Room	Type	Sq. Ft.	Dimensions	Ceiling Height	AV	Boardroom	Classroom	Banquet	Hollow Sq.	U-Shape	Theater	Reception
23rd	Brennan	Meeting Room	775 sq. ft.	27 ft. x 17 ft.	8.6 ft.		16	16	40	18	20	60	50
23rd	Tera	Meeting Room	658 sq. ft.	20 ft. x 21 ft.	8.6 ft.		14	16	32	16	16	40	50
23rd	Archimedes	Meeting Room	633 sq. ft.	20 ft. x 18 ft.	8.6 ft.	AV	14	16	32	16	18	40	45
23rd	Carver	Meeting Room	604 sq. ft.	—	8.6 ft.	AV	19	—	—	—	—	—	—
23rd	Nakamatsu	Meeting Room	461 sq. ft.	—	8.6 ft.		17	—	—	—	—	—	—
23rd	Wadley	Meeting Room	267 sq. ft.	—	8.6 ft.		8	—	—	—	—	—	—
23rd	Naismith	Meeting Room	242 sq. ft.	—	8.6 ft.		6	—	—	—	—	—	—
24th	Riverview	Classroom	2,643 sq. ft.	—	11 ft.	AV	—	Tiered: 76	—	—	—	—	—
24th	University North/South	Dining Room	2,643 sq. ft.	—	9 ft.	AV	—	—	130	—	—	170	185
24th	Cityview	Classroom	2,327 sq. ft.	—	11 ft.	AV	—	Tiered: 57	—	—	—	—	—
24th	University North	Dining Room	1,509 sq. ft.	69 ft. x 21 ft.	9 ft.	AV	35	45	80	30	24	92	100
24th	University South	Dining Room	1,134 sq. ft.	60 ft. x 19 ft.	9 ft.	—	26	30	50	22	17	78	85
24th	Jefferson	Boardroom	546 sq. ft.	—	9.6 ft.	AV	16	—	—	—	—	—	—
24th	Goode	Boardroom	543 sq. ft.	—	9.6 ft.	AV	16	—	—	—	—	—	—
24th	Curie	Meeting Room	379 sq. ft.	—	9.6 ft.	AV	10	—	—	—	—	—	—
24th	Mendeleev	Meeting Room	379 sq. ft.	—	9.6 ft.	—	10	—	—	—	—	—	—